

**AFDEX** helps you meet the theory

Die analysis

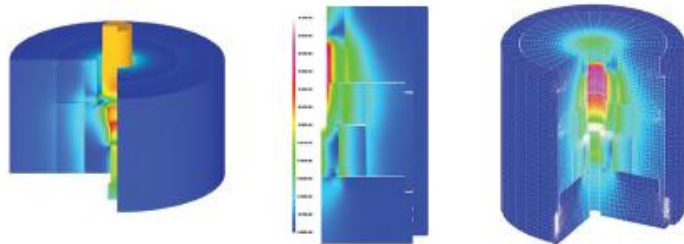

### System requirements

Item	2D	3D
PC	Pentium IV	Pentium IV
Memory	256MB	1G
Monitor	More than resolution 1280*1024	More than resolution 1280*1024
Hard disk	1G	100G
OS	Window NT/2000, XP, Vista, window7	Window NT/2000, XP, Vista, window7
Compatibility	DXF	STL
CPU	1GHz	2GHz

**3View**<sup>TM</sup>  
Machine to the Web!

**Sales Representative**  
3View.Com Inc.  
Tel : +82-31-776-0677  
Fax : +82-31-776-0673  
E-mail : info@e3view.com  
http://www.e3view.com

**MFRC**

Metal Forming Research Corporation

**Developer**  
Gyeongsang National University, KOREA  
Tel : +82-55-751-5316  
E-mail : msjoun@emaps.com  
http://www.afdex.com



**AFDEX** 

Adviser for Forging Process Design Expert

**2D/3D**

**3View**<sup>TM</sup>  
Machine to the Web!

# AFDEX

is a general-purpose metal forming simulator with new concepts for users.

## Key Features

- ① Rigid-Thermoviscoplastic Finite Element Method
- ② Intelligent Remeshing
- ③ Automatic Simulation of Multi-Stage Processes
- ④ Many User Friendly Capabilities
- ⑤ Easy-to-Learn and Many Fool-Proof Functions

## Accurate! : MAT

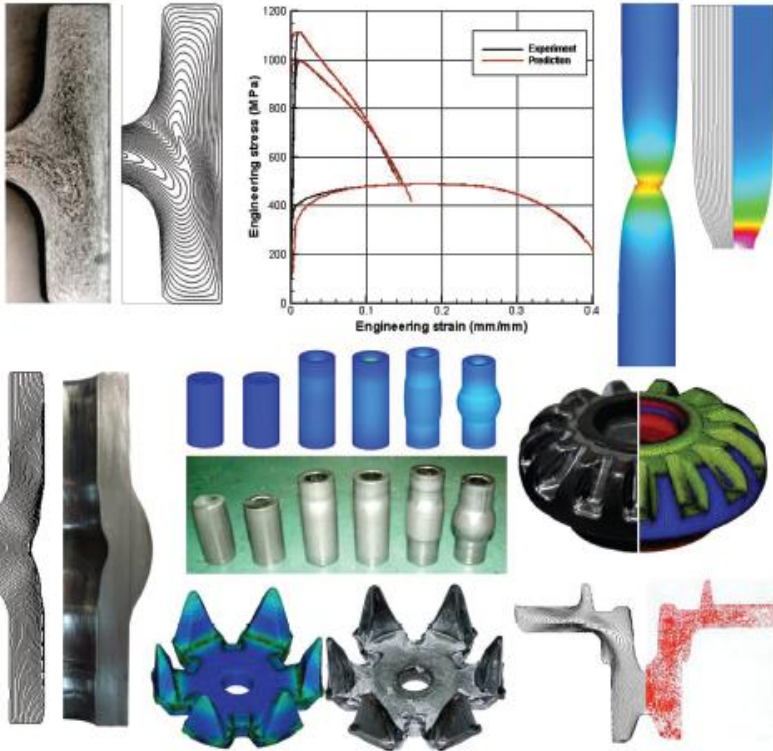

## Intelligent! : FEM

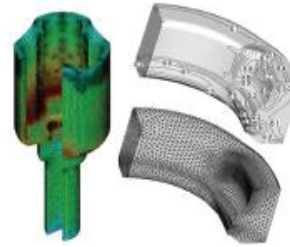

## Remeshing

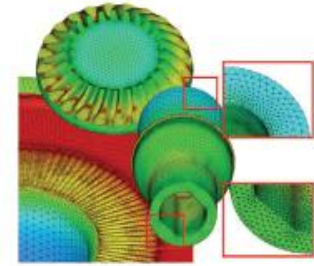

## User friendly

